

# COSTA RICA & THE PANAMA CANAL on the intimate ship *Star Breeze*

JANUARY 21–28, 2017 • 8 DAYS, 7 NIGHTS

Monteverde Cloud Forest Pre-Tour: January 18–21, 2017

**EARLY BOOKING SAVINGS:** Save \$500 per couple and receive free airfare when you book and pay in full by October 31, 2016. (see pricing page for details)

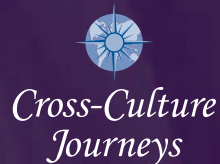

## ACCOMPANYING PROFESSOR

Markes Johnson, Charles L. MacMillan Professor of Natural Science, Emeritus  
& Gudveig Baarli, Research Scientist, Department of Geosciences





# COSTA RICA & THE PANAMA CANAL

on the intimate ship *Star Breeze*

Natural and constructed wonders combine in this week-long journey aboard the all-suite *Star Breeze*.

Costa Rica is one of the most ecologically diverse places on earth, with rainforest, cloud forest, volcanoes, mangroves and a profusion of wildlife. The rich colors of land, sea and sky are further brightened by brilliant tropical birds and floral abundance. Join Professor Markes Johnson and Research Scientist Gudveig Baarli on optional excursions that explore these environs, and enjoy life aboard *Star Breeze*, a sleek white 212-guest ship with opportunities for learning, renewal and conviviality. The grand finale of your cruise is a traversal of the Panama Canal. You may have imagined the rise and descent through the locks of this great waterway since childhood. This is your chance to experience the “path” that through all obstacles joined the Pacific to the Caribbean. Before the cruise you may take in more of Costa Rica’s magnificent biodiversity on a pre-cruise extension in the Monteverde Cloud Forest.





## Dear Alumni, Parents, and Friends of Williams,

We invite you to join Williams College and Professor Emeritus Markes Johnson in an exploration of the richly diverse tropical environments of Costa Rica and Panama. Home to hundreds of species of birds, primates, sea creatures, ancient trees, and brilliant flowering plants, the region's flora and fauna is ever abundant.



**Markes E. Johnson**  
*MacMillan Professor of  
Natural Science, Emeritus*

Our journey aboard the inviting and newly-renovated 212-guest ship *Star Breeze* follows the Pacific shore of Costa Rica, calling near Manuel Antonio National Park, Corcovado National Park, and a splendid botanical garden on Golfo Dulce. By joining the optional excursions led by Professor Johnson and his wife and collaborator, Research Scientist Gudveig Baarli, you'll explore all of these sites and more. Professor Johnson will also give talks on board, linking the geological record around you with the history of land and sea.

Your cruise ends with a daytime traversal of the Panama Canal. Passing through the canal may be the best way to appreciate what was required to

envision and build it, and what it has meant to the Americas, and indeed the world. Travelers report that the experience of the locks, machinery, and cargo expands one's sense of both nature and human enterprise.

With the ecological treasury of Costa Rica, outstanding shipboard accommodations, insightful commentary, and daytime passage of the Panama Canal, this cruise has much to offer! If you can arrive a few days early, join the pre-tour to the Monteverde Cloud Forest, a series of lush environments providing unique habitat for capuchin monkeys, sloths, tapirs, and a host of other rare inhabitants. There is simply so much to do and see; don't delay in reserving your spot for this one-of-a-kind adventure!

To book the cabin of your choice and save \$500 per couple/\$250 per person with free airfare, please send the attached registration form or call Cross-Culture Journeys at 800.491.1148 today.

With best wishes,

*Leila*

Leila Derstine, Alumni Travel-Study Coordinator  
413.597.4011 • Alumni-Travel@Williams.edu



# Costa Rica & the Panama Canal

January 21–28, 2017

Saturday, January 21

**DEPART U.S. • ARRIVE SAN JOSÉ, COSTA RICA • TRANSFER TO PUERTO CALDERA & BOARD STAR BREEZE • PREPARATIONS AND INTRODUCTIONS • WELCOME DINNER**

Arrive at Juan Santamaria International Airport, where you will be met and accompanied on the drive to Puerto Caldera on the Gulf of Nicoya. Board *Star Breeze*, settle into your suite and take part in the safety drill before the “Sail Away” at 6:00 p.m. After an introduction to the ship and the itinerary, enjoy your first dinner aboard as you cruise down the coast toward Quepos.

If you are joining the Monteverde Cloud Forest Pre-tour, see pre-tour itinerary on page 7 for today’s itinerary. **D**

*From some U.S. airports you can fly to San José in time to reach Puerto Caldera by late afternoon. In that case you may leave for Costa Rica on embarkation day. We highly recommend that you fly to Costa Rica on Friday, January 20, and take the pre-cruise overnight package. The cost of \$125 per person includes an overnight stay at the Marriott San José, the airport-hotel transfer, breakfast, taxes, and the transfer by coach to the ship on Saturday.*

Sunday, January 22

**ARRIVE QUEPOS • OPTIONAL GROUP EXCURSION TO MANUEL ANTONIO NATIONAL PARK • EVENING DEPARTURE TOWARD BAHÍA DRAKE**

Arrive this morning at Quepos, the gateway to Manuel Antonio National Park. This renowned park protects an extensive rainforest laced with paths for great viewing, a wealth of animal and bird life, and

several white-sand beaches. The featured optional shore excursion with Prof. Johnson is a nature walk through Manuel Antonio followed by swimming or beach time. Other optional excursions include a boat trip through the mangrove ecosystem, a drive to a village in the nearby Fila Chonta Mountains, a floating/paddling trip on one of the region’s rivers, and a zip-line rainforest canopy tour. At 6:00 p.m. *Star Breeze* will sail from Quepos along the coast toward Bahía Drake (Drake Bay). **B/L/D**

Monday, January 23

**ARRIVE BAHÍA DRAKE • OPTIONAL GROUP EXCURSION TO TERRABA-SIERPE WETLANDS & MANGROVES • CRUISE TO GOLFO DULCE**

Disembark at Bahía Drake, where Sir Francis Drake is said to have come ashore in the late 16th century. The beautiful coastline of sparkling coves, pristine beaches and rocky crags forms part of Corcovado National Park, a nature preserve that occupies nearly a third of the Osa Peninsula. The park conserves one of the few sizeable lowland tropical rainforests remaining in the world. The group optional excursion today takes you by boat to the Terraba-Sierpe National Wetlands, the largest mangrove reserve in Latin America. You will have several hours to explore



## Average temperature and precipitation ranges in season (in degrees Fahrenheit)

City	High	Low	Precipitation
Puerto Caldera, Costa Rica	79°	63°	0.1"
Panama City, Panama	88°	73°	2.7"

the river branches, watching for wildlife including Howler and Capuchin Monkeys, herons and other water birds, crocodiles, caimans and turtles. There will be a stop for a typical lunch in one of the restaurants along the river in Sierpe.

Among other optional excursions are a zip-line canopy tour, horseback riding with a naturalist guide, snorkeling, and a hiking tour that takes in forest, seashore, freshwater ponds and gardens. If you choose to swim today (seas permitting), you might find yourself in the company of marlins

## — TOUR INCLUSIONS —

- Airport-ship transfers (if purchasing trip with airfare and arriving on embarkation day)
- Seven nights' accommodation in outside stateroom on intimate ship *Star Breeze*
- Talks and discussion with Accompanying Professor Markes Johnson and Research Scientist Gudveig Baarli
- Onboard presentations by ship's naturalist; nightly destination briefings
- Services of a Cross-Culture group manager
- All meals during cruise, including beach barbecue on Isla de Coiba, vegetarian selections; special diets accommodated if known in advance
- "Early riser" continental breakfast through the morning; mid-afternoon coffee and snacks; fruit bowl in your cabin replenished daily
- All non-alcoholic beverages including cappuccino, espresso and other specialty drinks
- Entertainment system including DVD player; DVD collection in library for borrowing
- Excursions not labeled "optional"
- Use of water sports equipment (kayaks, snorkeling gear, etc.) in favorable sea and weather conditions
- Daily yoga, stretching or exercise classes
- Luggage handling for one bag per person throughout the trip
- All local taxes

### Included in Pre-Cruise Overnight Package

- One night accommodation in Superior First Class hotel in San José
- Breakfast
- All taxes
- Airport-hotel and hotel-ship transfers if purchasing trip with airfare and arriving on Friday, January 20

## — NOT INCLUDED —

- Airport transfers when purchasing cruise only or not arriving on days specified above
- Excursions labeled "optional"
- Port charges and fees (total \$295)
- Passport and airline baggage fees
- Internet access in staterooms or on library computers (available with purchase of card onboard)
- Alcoholic beverages
- 15% service charge added to bar charges, beverage package, and wine purchased with meals
- Gratuities for guides and drivers on optional excursions
- Personal expenses such as telephone, laundry, spa services and other items not listed as included (Laundry package available on board)
- Travel or health insurance

## — ACCOMMODATIONS —

LOCATION	ACCOMMODATIONS	RATING (Hotel & Travel Index)
At sea	<i>M/V Star Breeze</i>	Superior First Class equivalent
San José, Costa Rica <i>pre-cruise overnight package only</i>	Costa Rica Marriott San José	Superior First Class

[www.ccjourneys.com](http://www.ccjourneys.com) ✦ 800.491.1148 ✦ [www.smallshiptravel.com](http://www.smallshiptravel.com)

See our website for full terms and conditions.







and dolphins. After your day's adventure return to *Star Breeze*, which will set off around the peninsula for the Golfo Dulce. **B/L/D**

*Tuesday, January 24*

**GOLFO DULCE (PUERTO JIMÉNEZ) • OPTIONAL GROUP EXCURSION TO BOTANICAL GARDEN • GOLFITO**

Spend the day in Golfo Dulce, an area where both the jungle and the sea brim with diverse lifeforms. Foliage grows down the steep hillsides to the waterline, and the hoots of monkeys echo through the vine-laced trees. Join Prof. Johnson for a boat trip to view the rainforest that borders the gulf. You will visit Casa Orquideas, a garden with a great array of plants from the tropics and other regions of the world, and if weather permits, there will be opportunity to swim or enjoy the beach. Alternative optional

excursions include a visit to a traditional cacao plantation, a dolphin watch in part of the bay that *National Geographic* deems "the most biologically intense area on earth," and a kayak trip. In the late afternoon your ship will head across Golfo Dulce to call briefly at Golfito, known for its calm waters and lovely beaches. Then cruise the coast past the southernmost tip of Costa Rica to the blue Pacific and Panama's Isla de Coíba. **B/L/D**

*Wednesday, January 25*

**ISLA DE COÍBA, PANAMA • BEACH ACTIVITIES AND BARBECUE**

Isla de Coíba is designated a UNESCO World Heritage Site. The warm, clear waters teem with marine life surrounded by one of the largest coral reefs in the Pacific, and the island is home to ancient forests, rare plant and animal species and large

numbers of scarlet macaw. On a lovely secluded beach, enjoy a day of activities such as a stretching class, yoga, volleyball or bocce, and of course swimming, snorkeling and other water sports. The ship's naturalist will host nature hikes on the island (small fee). At midday the chef and culinary staff present a feast of grilled meats and shellfish with side dishes, salads, tropical fruits and freshly baked desserts. Stay and enjoy the beach and the island until your Sail Away at 6:00 p.m. *Note: The location of the beach barbecue depends on weather and sea conditions.* **B/L/D**

*Thursday, January 26*

**DAY AT SEA, WITH LECTURES AND ACTIVITIES ON BOARD • OPEN DECK BARBECUE DINNER**

This is your day at sea as *Star Breeze* rounds the Azuero Peninsula toward the Gulf of Panama. There will be a talk by Markes Johnson on the region's geological history and a session on the building of the Panama Canal. You'll have time to pursue other activities aboard, from spa treatments to reading to relaxing with friends.

End the day with a Windstar tradition, the barbecue on the pool deck (weather permitting). Featured are such dishes as grilled lobster, jerk chicken and seafood paella, as well as salads, grilled vegetables, fruits and desserts. The ship's two musical duos take turns performing, and later the deck is cleared for line dancing. Overnight your ship will continue toward the coast of Panama. **B/L/D**

*Friday, January 27*

**TRANSIT OF PANAMA CANAL**

In the early morning, when lights still illuminate the inner workings of the waterway, pass Fort



Amador and enter the Panama Canal for the 51-mile voyage across the Isthmus and through the Continental Divide to the Caribbean. More than 80,000 workers took part in this massive construction project, carving through earth and granite and building three sets of enormous locks. Vessels ranging from vast container ships to small passenger craft such as *Star Breeze* are raised and then lowered some 85 feet over the course of 8–10 hours.

You will pass through the two flights of the Miraflores Locks and the single stage of the Pedro Miguel Locks, with the rainforest of Soberania National Park on the ship's starboard side. Continue through the Galliard (Culebra) Cut, the deepest portion of the canal that cuts through the Continental Divide, and emerge on Lake Gatun, which is the source of the millions of gallons of fresh water that fill the locks. Continuing toward Limon Bay and the Caribbean, your ship will pass through the three-stage Gatun Locks and will arrive in Colón toward evening. This city is shaped by the Zona Libre, the largest free-trade zone in the Americas; it also offers colonial architecture and fine beaches. Celebrate your journey at the farewell dinner with friends old and new. *B/L/D*

*Saturday, January 28*

---

**COLÓN: DISEMBARK *STAR BREEZE* •  
TRANSFER TO PANAMA CITY AIRPORT •  
RETURN TO U.S.**

Following breakfast aboard, disembark and transfer to Panama City's Tocumen International Airport for your return flight to the U.S. *B*







# Monteverde Cloud Forest Pre-Tour Extension

**\$595 per person • additional \$195 for single supplement**

**January 18–21, 2017**

*Wednesday, January 18*

## **DEPART U.S. • ARRIVE SAN JOSÉ, COSTA RICA • OVERNIGHT NEAR AIRPORT**

Depart for San José, Costa Rica, where you will land at Juan Santamaria International Airport. Transfer by airport shuttle to your nearby hotel. If you arrive by early afternoon, you could take a taxi into San José to visit the Pre-Columbian Gold Museum, the ornate National Theater, or other sites of interest. Have dinner on your own and return to your hotel for the night.

*Thursday, January 1*

## **MORNING DRIVE TO MONTEVERDE • SUGAR MILL TOUR & MEETING WITH LOCAL FAMILY • BANANA AND COFFEE PLANTATIONS • TIME TO EXPLORE ON YOUR OWN**

You will be met at the airport or your hotel and driven to the Monteverde Cloud Forest, which was founded by a group of Quakers seeking a place to live harmoniously with nature. The Cloud Forest Reserve is one of the outstanding wildlife sanctuaries in the tropics. Its six ecological zones are habitat for some 2,000 native plant species, over 100 mammals including jaguar and ocelot, and more than 300 birds including the Resplendent Quetzal.

Tour a sugar mill (*trapiche*) to meet a local family and learn about the production of sugar from cane. You will also see banana plantations and aspects of coffee farming and production. Stop for lunch at a local restaurant before returning to your hotel, where you have the rest of the day on your own to explore the area. **B/L**



*Friday, January 20*

## **HIKE ON CLOUD FOREST RESERVE TRAILS • TIME ON YOUR OWN FOR OPTIONAL ACTIVITIES**

After breakfast, meet your guide in the lobby for a hike through the well-kept trails of the Monteverde Cloud Forest Reserve. You will find cooling waterfalls, a great variety of colorful flora and fauna and, with luck, a Quetzal, one of the most beautiful of all birds. After lunch together in a local restaurant you have the afternoon free for your choice of optional activities, which range from a visit to the Butterfly Garden to a zip-line canopy tour. **B/L**

*Saturday, January 21*

## **TRANSFER TO PUERTO CALDERA • BOARD STAR BREEZE • PREPARATIONS AND INTRODUCTIONS • WELCOME DINNER**

Leave the hotel after breakfast for the drive through the mountains to the coast, where your ship *Star Breeze* will be waiting at Puerto Caldera. **B**

*For the rest of the day, see the cruise itinerary for this date on page 3.*





## Monteverde Cloud Forest Pre-tour Extension

### — PRE-TOUR INCLUSIONS —

- One night's accommodation at Superior Tourist Class hotel in Alajuela (near San José Airport)
- Meals as mentioned in itinerary
- Two nights' accommodation at First Class or similar hotel in Monteverde
- Excursions as described in the itinerary
- Transfer from airport hotel to Monteverde and from Monteverde to Puerto Caldera

### — NOT INCLUDED —

- Gratuities for guides, drivers and hotel staff
- Meals, tours and transfers not listed in the itinerary
- Alcoholic beverages

### — ACCOMMODATIONS —

LOCATION	ACCOMMODATIONS	RATING (Hotel & Travel Index)
Monteverde, Costa Rica	Fonda Vela or Fonda Vela Hotel	First Class (or similar)

[www.ccjourneys.com](http://www.ccjourneys.com) ✦ 800.491.1148 ✦ [www.smallshiptravel.com](http://www.smallshiptravel.com)

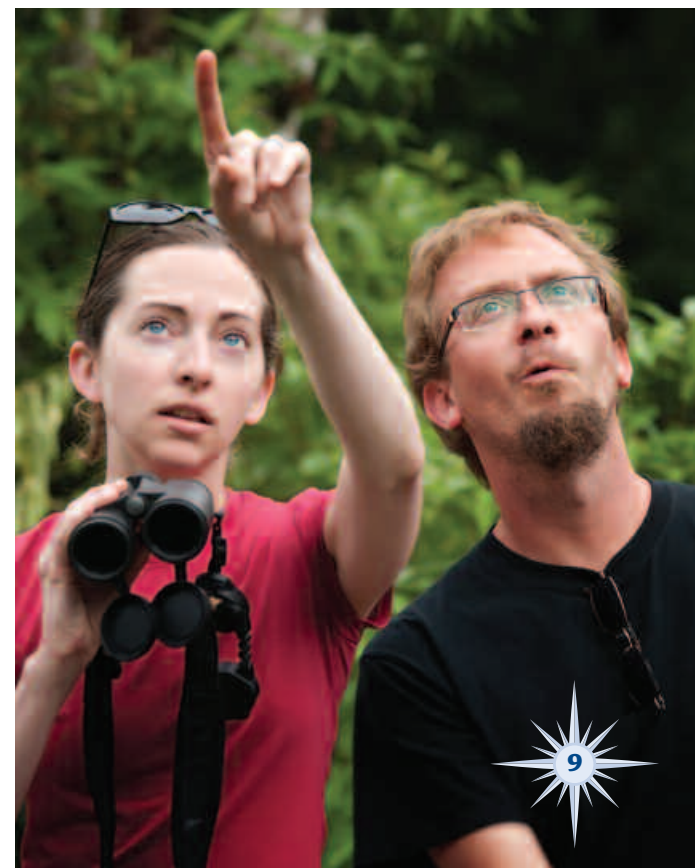



# *Star Breeze*





# Star Breeze

## Ship Description

Windstar Cruises acquired and thoroughly updated *Star Breeze* in 2015, creating an all-suite ship small enough to enter small harbors and coves yet large enough to provide spacious suites and an array of facilities and services.

All 106 suites have a sitting room at the outside, allowing views of sea, coast and sky. Unless otherwise noted they have queen beds that can be reconfigured as twins. The 64 Ocean View Suites with picture windows and 36 Balcony Suites with full-length windows and French-style balconies each measure 277 sq ft. The Owner's Suites, at 575 sq ft, and the four Classic Suites, two at 400 sq ft and two at 530 sq ft, have private verandas.

Suites are equipped with Egyptian cotton bedding, robes and slippers, a walk-in closet and ample drawer space, flat-screen TV with DVD and CD players, and Bose SoundDock® system, a mini-bar/refrigerator, a safe, and 110/220 outlets. The bath features a granite countertop, a tub/shower combination, and L'Occitane® bath products. Internet cards may be purchased at Reception for use in your suite or the Computer Room.

Elevators connect all the passenger decks, and modified wheelchair-accessible suites are available. These are Suites 134, 136, 232 and 234, which have fixed queen beds, a shower with a small lip, and a bathroom step with a portable ramp. Doorways are standard.[See note on Physical Requirements for this cruise.] A doctor and limited medical facilities are available on board.



Public spaces include a large lounge with panoramic windows, the Star Bar outdoors on deck, the piano lounge Compass Rose, and the Show Lounge with evening entertainment. There's a theater with a very large flat-screen television for watching news or films. On the Sun Deck is a small counter-current pool and a whirlpool; you'll also find a hot tub on Deck 5. The ship has a library with books and DVDs, a shop, a small casino, a fitness center that offers yoga and other activities, and a spa. Smoking is permitted only in an area adjacent to the Star Bar or on an outer deck aft of the lounge.

The Water Sports Platform on Deck 3 is opened when the ship is at anchor and the seas are calm enough for kayaking, swimming, paddle boarding or pedal boating. Motorized Zodiac inflatable craft will transport groups as needed, and at some ports a tender motors at intervals to shore and back.

The main restaurant aboard is AmphorA, where dinner is served nightly. Travelers on *Star Breeze* have been pleased with the variety of meat entrées, the fresh fish, and the attention to vegetarian options. Seating is open; dress is elegantly casual here and for evenings in the lounge (no shorts, t-shirts, tank tops, jeans, flip-flops or tennis shoes). Casual buffet as well as full-service dining is available at breakfast and lunch at Veranda, with indoor and terrace seating. A third venue, the intimate Candles, offers a chance to dine under the stars one evening during your cruise if weather permits.

In addition, continental breakfast is available by the Yacht Club coffee bar from 6:00 a.m. until noon, coffee beverages such as cappuccino are offered through the day, and appetizers are served most evenings before dinner. Room service is always available.



# Star Breeze

## Deck Plan

Owner's Suite (OW)
Classic Suite (CS)
Balcony Suite 1 (BS1)
Balcony Suite (BS)
Ocean View Suite 3 (S3)
Ocean View Suite 2 (S2)
Ocean View Suite 1 (S1)
Ocean View Suite (S)

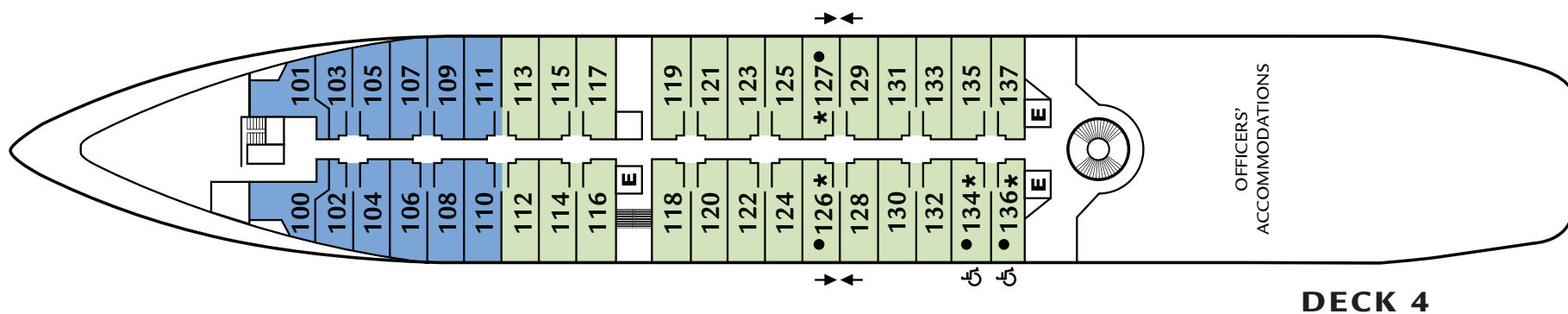
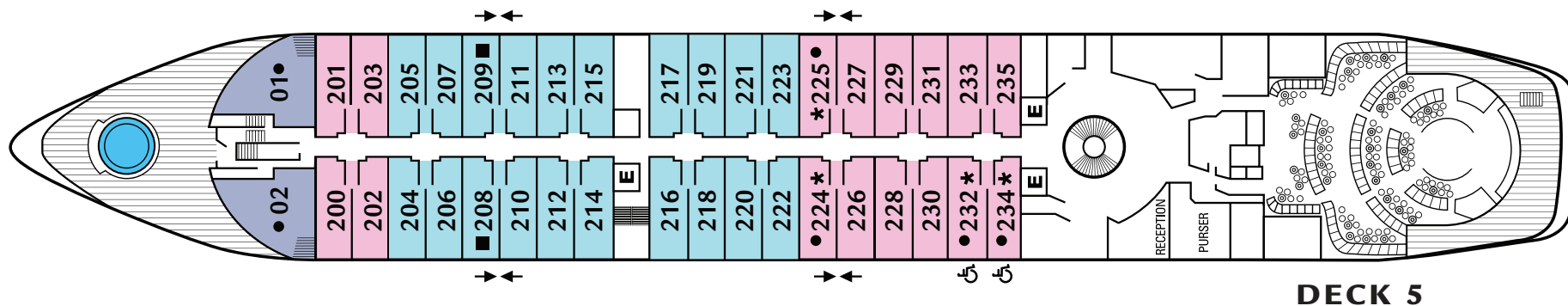
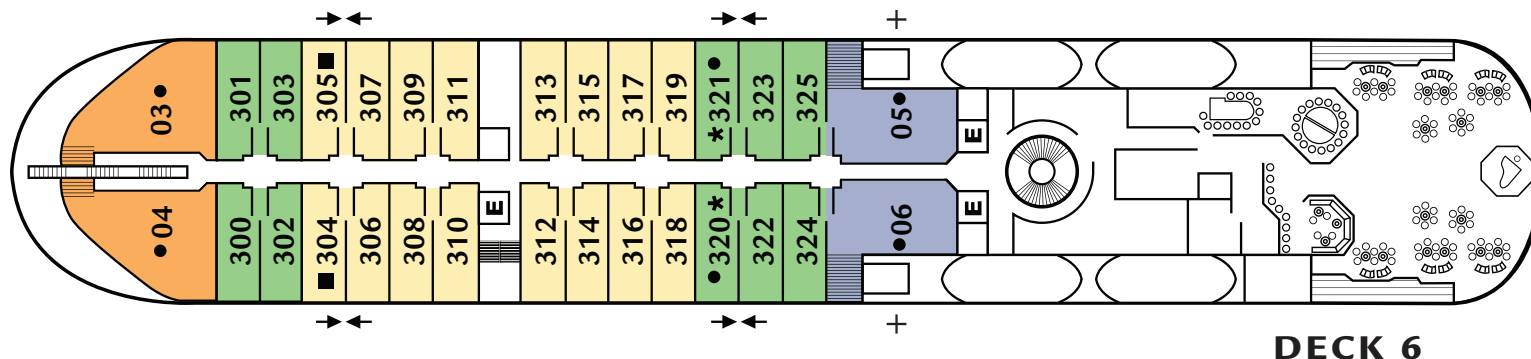

- + RESTRICTED VIEW  
 ↓  
 ↑ ADJOINING SUITES  
 E ELEVATOR

- **ONE QUEEN SIZE BED ONLY**  
(no twin option)
- \* **SHOWER ONLY**
- ♿ **MODIFIED ACCESSIBLE SUITES**  
Feature a full-size bed (no twin option)

*Suites 134, 136, 232 & 234, are modified accessible, shower only with a small lip into shower, a step into the bathroom with a portable ramp, standard interior and exterior doorways.*



# Star Breeze

## Schematics & Ship Data

### Owner's Suites (OW):

575 square feet (54 square meters)

### Classic Suites (CS):

Forward Suites, 01 and 02:

400 square feet (37 square meters)

Midship Suites, 05 and 06:

530 square feet (49 square meters)

Suites with 3rd berths: 05 and 06

### Balcony Suites (BS, BS1):

277 square feet (26 square meters)

Suites with 3rd berths:

204, 205, 222 and 223

### Ocean View Suites (S, S1, S2, S3):

277 square feet (26 square meters)

Suites with 3rd berths: 112–115, 300 and 301

### Modified Accessible Suites:

277 square feet (26 square meters),  
(Suites 134, 136, 232, 234)

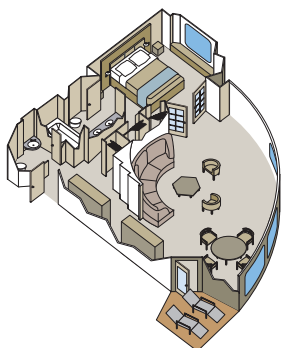

*Owner's Suite, Forward*



*Classic Suite, Midship*

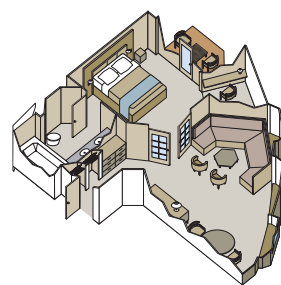

*Classic Suite, Forward*

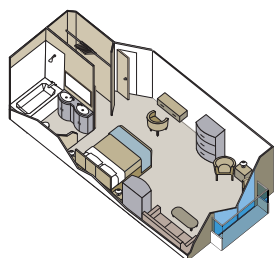

*Balcony Suite*

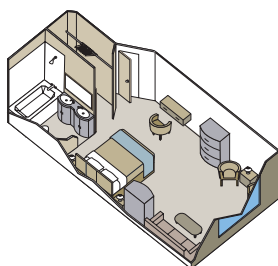

*Ocean View Suite*

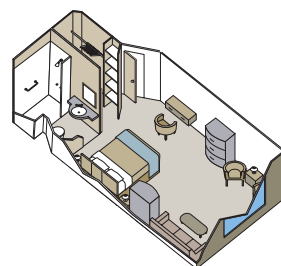

*Ocean View Accessible Suite*

## SHIP DATA

Built:	1989; last renovated 2015
Length:	440 feet
Beam (width):	63 feet
Draft:	16.5 feet
Guest Decks:	6
Propulsion:	Twin propeller, driven by four Bergen marine diesel engines
Cruising speed:	15 knots
Crew:	145
Guest capacity:	212
Staterooms:	106 suites, all outside with ocean views
Registry:	Bahamas

### Suites with 3rd berths:

05, 06, 204, 205, 222, 223, 112–115, 300 and 301

**Views from Classic Suites 05–06 are obstructed by lifeboats**

### Fixed queen bed, shower only:

Classic Suites and 320, 321, 224, 225, 232, 234, 126, 127, 134, 136 (Cabins in *italics* are accessible)



# Costa Rica & the Panama Canal

## Dates & Prices



**BONUS  
SAVINGS**

**FREE AIRFARE PLUS  
SAVE \$500**

**PER COUPLE**

*Book & pay in full by  
October 31, 2016*

### January 21–28, 2017

### Monteverde Cloud Forest Pre-tour • January 18–21, 2017

	Category S	Category S1	Category S2	Category S3	Category BS	Category BS1	Classic Suite	Owner's Suite
Price before OCTOBER 31, 2016	\$3,495	\$3,895	\$4,395	\$4,595	\$4,795	\$4,995	\$7,495	\$8,495
Price after OCTOBER 31, 2016	\$3,745	\$4,145	\$4,645	\$4,845	\$5,045	\$5,245	\$7,745	\$8,745

Please note, pricing is per person with double occupancy.

**Pricing includes airfare!** Free airfare from Miami is included in the pricing chart above. We are happy to arrange airfare from the airport of your choice, please call 800.491.1148 for details.

**Pre-cruise overnight package includes stay at Superior First Class or Moderate Deluxe hotel, breakfast, taxes and transfers: \$125 per person/double occupancy or \$200 single supplement**

**Port charges and fees** \$295

**Single supplement** 175% for all Categories; 200% for Classic and Owner's Suites

**We are able to book First Class—please call 800.491.1148 for more information.**

*Deduct \$400 if you are making your own air arrangements. Airport-ship transfers may be purchased at an additional cost if you are arriving and departing on the scheduled cruise dates.*

Hometown airports*	Pricing from your home airport to Miami
Atlanta, Baltimore, Charlotte, Orlando, Raleigh-Durham, Tampa, Washington DC	only an additional \$200
Boston, Hartford, Newark, New York, Philadelphia, Pittsburgh	only an additional \$250
Chicago, Cleveland, Dallas-Fort Worth, Detroit, Houston, Kansas City, Minneapolis, St. Louis	only an additional \$350
Denver, Los Angeles, Phoenix, Portland, Salt Lake City, San Diego, San Francisco, Seattle	only an additional \$400

\*Please call for prices from other airports

### Physical condition

The group excursions have been chosen to include travelers who do not undertake strenuous hikes and do not snorkel. To enjoy these excursions you must be able to enter and exit a tender, and for most you are asked to walk moderate distances on terrain that may be rough. The ship's elevators connect all the passenger decks, and several cabins are modified to be accessible. If you are considering the trip and wish to discuss the physical requirements, please call Cross-Culture Journeys at 800-491-1148.

### Itinerary

The Captain may alter the route or activities, either rescheduling certain events or substituting others for any that he deems potentially unsafe. Unless weather conditions call for such changes we expect the itinerary to be followed.



# Costa Rica & the Panama Canal

## Registration Form

A deposit of \$1,000 per person is required to confirm your reservation for **Costa Rica & the Panama Canal**.

- ☐ I/we would like to also reserve the Monteverde Cloud Forest Pre-tour Extension (additional deposit of \$250 per person applies).

The applicable deposit is being paid by:

☐ the enclosed check for \$\_\_\_\_\_

☐ my credit card for \$\_\_\_\_\_

*(If paying by credit card, please complete the credit card information at right)*

### Traveler One

NAME \_\_\_\_\_

ADDRESS \_\_\_\_\_

CITY \_\_\_\_\_

STATE \_\_\_\_\_ ZIP \_\_\_\_\_

HOME PHONE \_\_\_\_\_

BUSINESS PHONE \_\_\_\_\_

EMAIL \_\_\_\_\_

### Traveler Two

NAME \_\_\_\_\_

ADDRESS \_\_\_\_\_

CITY \_\_\_\_\_

STATE \_\_\_\_\_ ZIP \_\_\_\_\_

HOME PHONE \_\_\_\_\_

BUSINESS PHONE \_\_\_\_\_

EMAIL \_\_\_\_\_

### Preferred departure city

TRAVELER ONE \_\_\_\_\_

TRAVELER TWO \_\_\_\_\_

- ☐ Check here if you would like to purchase the program on a land/cruise-only basis.

I/we would like to request a cabin upgrade:

- ☐ Category S1    ☐ Category S2    ☐ Category S3  
☐ Category BS    ☐ Category BS1  
☐ Classic Suite    ☐ Owner's Suite

- ☐ I wish to share a room or cabin with:

- ☐ I prefer a single room, subject to availability.

- ☐ I would like to share a twin room, if a roommate is available (shares are not guaranteed).

- ☐ I authorize Cross-Culture to charge the applicable deposit per person, per program or segment of combination programs to the following credit card:

CREDIT CARD NUMBER \_\_\_\_\_

EXPIRATION DATE \_\_\_\_\_ SECURITY CODE \_\_\_\_\_

*(Our bank requires the embossed digits plus the last three digits printed in the signature box on the back of your card)*

CARD HOLDER'S NAME (as it appears on the credit card) \_\_\_\_\_

SIGNATURE—TRAVELER ONE \_\_\_\_\_

SIGNATURE—TRAVELER TWO \_\_\_\_\_

*By making a deposit and enrolling in a Cross-Culture travel program, I am indicating that I have read and understand and agree to the General Terms and Conditions included in this package and on the website(s).*



**Cross-Culture  
Journeys**

Toll Free: 800.491.1148  
Fax: 413.253.2303

12 White Pine Road  
Amherst, MA 01002

travel@ccjourneys.com • www.ccjourneys.com



# Costa Rica & the Panama Canal

## Terms & Conditions



Please read this information carefully, as payment of the \$1,000 deposit per person represents your agreement with the following Terms and Conditions.

Your deposit can be charged to a MasterCard or Visa credit card or paid by check. If you make your reservation after the final payment date, payment in full will be required at the time of the booking. Final payment for land tours is due at least 95 days prior to departure. Make your check payable to "Cross-Culture, LLC" and send it to: 12 White Pine Road, Amherst, MA 01002. The final payment for small-ship cruises is due at least 120 days prior to departure. If final payment is not paid when due, Cross-Culture Journeys (CCJ) reserves the right to regard the reservation as cancelled. If the trip is fully booked when we receive your deposit, we will return your payment, or with your authorization, we will retain your deposit and place your name on a priority waiting list in case other participants cancel.

### CANCELLATIONS, REFUNDS AND CHANGES

If you find you must cancel your trip, you must send Cross-Culture Journeys written notice of your cancellation, by mail, e-mail, or fax. All refunds are based on the date the written notice is received in the Williams College office. No partial refunds allowed. Refunds are based on the following schedule:

#### FOR CRUISES

##### (INCLUDING PRE/POST TOUR EXTENSIONS)

Days prior to departure	Charge
120 days or more: \$500 (plus \$125 for extensions)	
119-90 days:	50% of cruise price
89-61 days:	75% of cruise price
60 days or fewer:	100% of cruise price (no refund)
Any changes to reservation: \$150 administrative fee	

Changes to post-tour extension or departure city will result in a \$100 per person administrative fee in addition to any fees or charges imposed by third parties.

Name changes are considered a cancellation, and the above-listed charges apply. If you are a no-show, if you cancel your trip after the departure date, or if you leave a trip already in progress, you will not receive any refund for any unused portion of your trip.

If Cross-Culture Journeys cancels a trip, we will refund all monies paid to Cross-Culture Journeys.

*Note: Air refunds, if any, are determined by the individual airlines. Cross-Culture Journeys, may, in order to take advantage of schedules and competitive pricing, purchase airlines tickets in advance. These tickets are non-refundable within 95 days of departure.*

### TOUR PRICING & INCLUSIONS

Tour prices quoted include accommodations based on double occupancy; airfare from your gateway city (when purchasing tour with airfare), meals, performances, admissions and scheduled group activities as noted in the itinerary, hotel taxes, airport transfers for group flights, baggage handling for two bags per person, services of a Cross-Culture Journeys Travel Guide (if applicable), gratuities to hotels (does not include gratuities for the guide and driver or for shipboard staff), restaurants, and local guides (does not include gratuities for the guide and driver). Please note that air upgrades, airline taxes, fuel surcharges, departure fees, governmental fees and port charges are subject to change.

### NOT INCLUDED IN YOUR TOUR PRICE

Passport and visa fees; airfare from your hometown to your gateway city; airline and governmental taxes, fees and surcharges; optional activities or shore excursions; gratuities to program guide and driver, and to shipboard staff; personal expenses such as telephone, communication charges, laundry, beverages, room service, and meals not specified; excess baggage fees, departure, airport and port charges (which will be listed as separate items on your invoice; independent transfers when purchasing a land-only package; flights connecting two or more programs and cancellation, travel and health insurance.

### PASSPORTS & VISAS

A valid passport is required for all Williams College/CCJ programs. A visa may be required for some of our programs. As we continue to add new destinations, it is your responsibility to check with the appropriate country for their visa requirements. Williams College and/or CCJ is not responsible in any way for providing you with information related to passport and/or visa requirements. Williams College and/or CCJ does not accept any responsibility in your failure to secure the necessary documentation for your trip.

### HEALTH & WALKING

Participants in this Williams College and CCJ program should be in good physical condition and prepared to enjoy walking, often on uneven terrain. We ask you to appraise your own capabilities honestly. And, we ask that you be considerate of the other group members and do not delay the scheduled group activities. We do not provide assistance if you require the use of a wheelchair or have other personal needs; in such cases a companion who will assist you must accompany you. Williams College and/or CCJ reserves the right to decline to accept or retain any participant should such person's health or deportment impede the operation of the trip or enjoyment of any other participant. If Williams College and/or CCJ decides not to retain a participant during the trip, Williams College and/or CCJ assumes no financial responsibility for any unused portion of the trip or for any additional expenses incurred by the participant.

### TRAVEL INSURANCE—WE STRONGLY RECOMMEND THAT YOU PROTECT YOURSELF AND YOUR INVESTMENT IN CASE YOU HAVE TO CANCEL OR INTERRUPT YOUR VACATION.

This coverage will offset cancellation charges in the event of illness before or during your trip. Trip Cancellation/Interruption, Medical Expense/Emergency Assistance, Baggage and Personal Effects, and Baggage/Travel Delay are some of the recommended benefits. Details and an insurance brochure will be sent from Williams College.

### PHOTOGRAPHY ON TOUR

Cross-Culture Journeys reserves the right to take photographs or video during the operation of any tour or part thereof, and to use the resulting images or video for promotional purposes. By booking a reservation with Williams College and CCJ, you agree to allow your image to be used for such purposes, without compensation. If you prefer that your image not be used, you must identify yourself to the guide at the commencement of the tour.

### RISK ACKNOWLEDGMENT AND LIABILITY RELEASE

Each person signing this Risk Acknowledgment and Liability Release on the registration form agrees as follows.

I am voluntarily participating in this trip with the knowledge of the risks and dangers to person and property involved in international travel, including but not limited to risks of physical exertion, forces of nature, wild animals, transportation failures (whether due to cancellation, accident or equipment breakdown), impure or tainted food or water, civil unrest, terrorism, crime, high altitude, accident or illness, unavailability or poor quality of medical supplies or services, and stolen or lost luggage. I accept these risks and acknowledge (i) that I am responsible for my own welfare and safety and (ii) that neither Cross-Culture Journeys nor The President and Trustees of Williams College, including their officers, employees and agents, is responsible or able to prevent any injury, illness, loss or harm that I may incur as a result of participating in this trip.

In consideration of being allowed to participate in this trip, I hereby release, waive and covenant not to sue, and do hereby indemnify and agree to hold harmless, Cross-Culture Journeys and The President and Trustees of Williams College, their officers, trustees, employees and agents (the "Indemnitees"), from and for any and all such liability for any loss, injury or damage, including without limitation any and all such liability arising from the negligence of the Indemnitees, which may be sustained by me during, or as a result of, or directly or indirectly related to my participation in this trip.

I have read, and understand, this Risk Acknowledgment and Liability Release, and I agree that this agreement shall be binding upon me and my heirs, assigns, personal representatives and estate. This agreement shall be governed by, and interpreted and enforced in accordance with, Massachusetts law.

*For full Terms and Conditions please contact 800.491.1148.*